



Fitwel[®] Social Performance[™]

a ground-breaking new entity-wide solution



We're changing the ESG landscape by connecting health to value.

Why Focus on 'S'?

Demand for 'S' Metrics

46%

of investors find the 'S' to be the most difficult ESG factor.¹

Employee Satisfaction

75%

of employees expect employer support for health and well-being.²

Adapting Technology

90%

of companies plan to boost their ESG investments in the next 3 years.³

Sources: 1 (BNP Paribas CIB. 2019), 2 (JLL. 2020), 3 (KPMG. 2024)

Fitwel[®] Social Performance[™] (FSP) is a comprehensive entity-wide ESG solution and with Fitwel's v3 asset certification, it offers 100% portfolio coverage - **an industry first.**

Why it Matters

Quantify 'S' Impact on Asset Value

- Align with Global Standards
- Enhance health & financial outcomes
- Unlock peer benchmark data
- Improve ESG Reporting & earn GRESB points

Benefits

- Increased ROI
- Reduced Risk Exposure
- Increased Employee Productivity
- Reduced On-Site Costs
- Increased Tenant Satisfaction



G R E S B

Recognized for
GRESB 2024

Move beyond Arbitrary Social Efforts

Adopt an evidence-based, structured approach to quantify how assets impact people—and how people financially impact assets using Social Performance[™].

FITWEL & Design is a registered trademark of the U.S. Department of Health & Human Services (HHS). Participation by The Center for Active Design and/or any other organization does not imply endorsement by HHS.

FITWEL SOCIAL PERFORMANCE | OVERVIEW



Use 2024 to Unlock Value

Connect with our team to learn how Fitwel[®] Social Performance[™] can enhance your ESG strategy for 2025.



Essentials & Resources

Pathways & Asset Types (Wide Project Range)

Including Built & Design pathways for Multifamily Residential, Senior Housing, Student Housing, Office, Retail, Commercial Site, Community Site

How to Get Started

- 1 Define entity & goals
- 2 Set scale (total assets within entity vs total assets reporting)
- 3 Set targets for each outcome (i.e. Create Resilience)
- 4 Assess & submit by 12/15/2024

Pricing (per asset USD)

Validated Benchmark	\$1,000
Self-Generated Benchmark	\$750
Custom pricing available	20+ assets

Resources

Fitwel Platform	Presentation Deck
Help Center	Strategy List Overview
Website	Fitwel Team

Images: (Above) Perkins&Will Toronto | Photo Courtesy of Perkins& Will, (Right) Lehigh University | Photo Courtesy HGA

FSP Key Takeaways

More than a certification – it's a validated benchmark integrating social impact, health, and well-being into investment strategies.

Why Fitwel?	Takeaway
Elevate 2025 ESG Performance	Effortlessly boost coverage and GRESB performance—no prerequisites or minimum performance requirements.
Unlock Value & Manage Risk	Enhance portfolio value & manage risk with tailored, research-backed strategies
Tailored Solutions for your Goals	Benefit from tech upgrades for improved efficiencies, data inputs, & tracking
Streamlined Reporting	Set baselines & generate gap analyses for continuous improvement
Trusted Validated Data	Leverage globally recognized third-party validation & peer benchmarking to reinforce data credibility

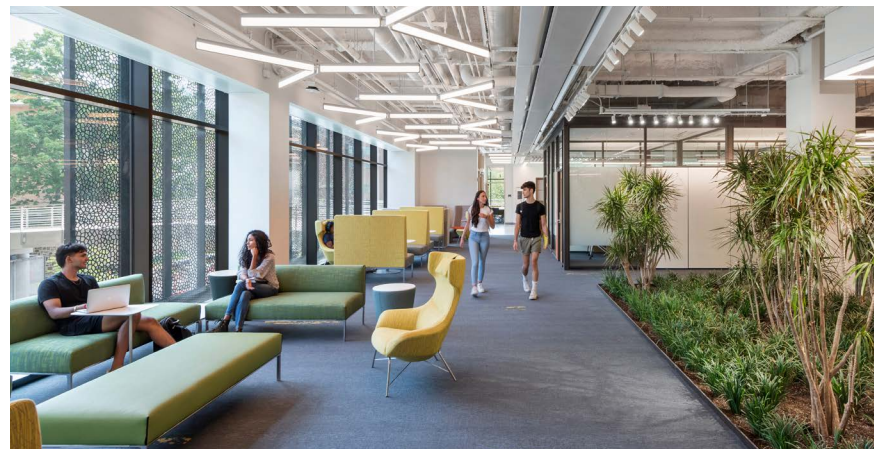

Start today.

Achieve 2025 success by submitting your projects by the 12/15 deadline for inclusion in 2025 ESG reporting

